

Chest Freezer Side View

FREEZER SPECIFICATIONS		
CAPACITY	25 CUBIC FEET	
STYLE	CHEST	
NET WEIGHT	300 LBS.	
SHIPPING WEIGHT	425 LBS.	
INTERIOR DIMENSIONS		
INTERIOR WIDTH	76.75"	194.9 CM
INTERIOR DEPTH	23.50"	59.7 CM
INTERIOR HEIGHT	24.88"	63.2 CM
EXTERIOR DIMENSIONS		
EXTERIOR WIDTH	83.25"	211.5 CM
EXTERIOR DEPTH	32.00"	81.3 CM
EXTERIOR HEIGHT	33.75"	85.7 CM
EXTERIOR CRATED DIMENSIONS		
CRATED WIDTH	103.0"	261.0 CM
CRATED DEPTH	46.00"	166.0 CM
CRATED HEIGHT	55.00"	139.0 CM

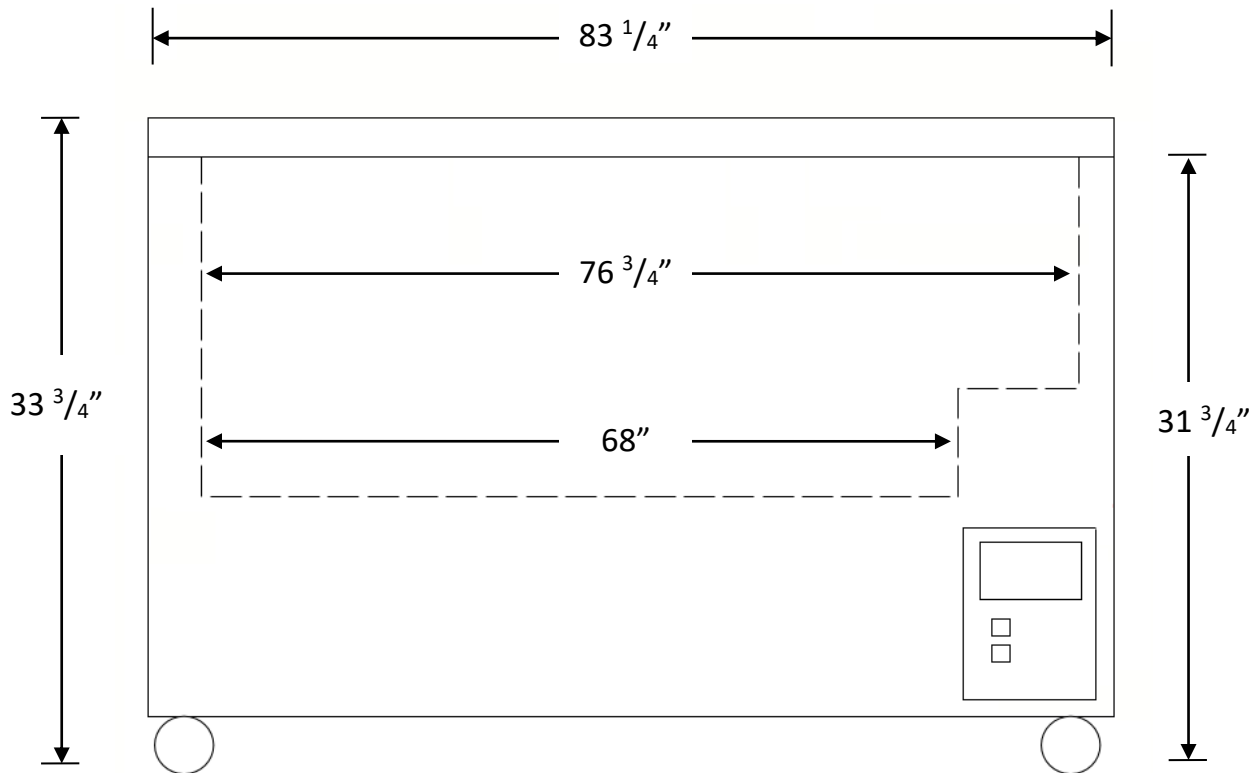

Chest Freezer Front View